



## STL1350/..-3.5-H-BLACK-HT

## Technical Data

Wire Sizes		Insulating Material	
Solid min	-	Material	LCP
Solid max	-	Flammability Class	UL 94 V-0
Stranded (flexible) min		<b>Temperatures</b>	
Stranded (flexible) max	-	Operating Temperature	-30 °C - 105 °C
Stranded with Ferrule min		<b>Wave Soldering Process</b>	
Stranded with Ferrule max	-	Soldering Temperature, recommended	265 °C
Stranded with Ferrule min		Peak Soldering Time, recommended	3 s / 10 s
<b>Dimensions</b>		<b>Reflow Process</b>	
Stripped Length	-	Soldering Temperature, recommended	217 - 245 °C
PCB Hole Diameter	1.3 mm	Peak Soldering Time, recommended	60 s
<b>Materials</b>			
Contact Pin	Brass		

## Colours

■ BLACK, RAL 9011

Colours according to RAL, there may be variations on colour due to production conditions.

## Counterparts (Spacing 3.5 mm)

Terminal Block

AK1350

## Order Data (Spacing 3.5 mm)

Poles	Width (mm)	Article Designation	Article Number	PU
2	7.00	STL1350/2-3.5-H-BLACK-HT	51350025101E	100
3	10.50	STL1350/3-3.5-H-BLACK-HT	51350035101E	100
4	14.00	STL1350/4-3.5-H-BLACK-HT	51350045101E	100
5	17.50	STL1350/5-3.5-H-BLACK-HT	51350055101D	50
6	21.00	STL1350/6-3.5-H-BLACK-HT	51350065101D	50
7	24.50	STL1350/7-3.5-H-BLACK-HT	51350075101D	50
8	28.00	STL1350/8-3.5-H-BLACK-HT	51350085101D	50
9	31.50	STL1350/9-3.5-H-BLACK-HT	51350095101D	50
10	35.00	STL1350/10-3.5-H-BLACK-HT	51350105101D	50
11	38.50	STL1350/11-3.5-H-BLACK-HT	51350115101D	50
12	42.00	STL1350/12-3.5-H-BLACK-HT	51350125101D	50
13	45.50	STL1350/13-3.5-H-BLACK-HT	51350135101D	50
14	49.00	STL1350/14-3.5-H-BLACK-HT	51350145101D	50
15	52.50	STL1350/15-3.5-H-BLACK-HT	51350155101D	50
16	56.00	STL1350/16-3.5-H-BLACK-HT	51350165101D	50
17	59.50	STL1350/17-3.5-H-BLACK-HT	51350175101D	50
18	63.00	STL1350/18-3.5-H-BLACK-HT	51350185101D	50
19	66.50	STL1350/19-3.5-H-BLACK-HT	51350195101D	50
20	70.00	STL1350/20-3.5-H-BLACK-HT	51350205101D	50

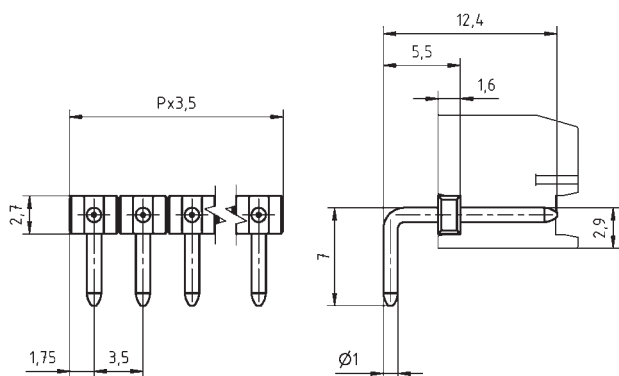

## Ratings



Usegroup	B	C	D	
Rated Voltage	150 V	-	-	125 V
Rated Current	9 A	-	-	8 A
Overtoltage Category				III
Test Voltage	1.3 kV	-	-	2.5 kV
Pollution Degree				3