

Series 1060/G

- Test probe for cable harness testing
- Test probe geometry for position test
- Screwable - threaded design - against the creeping out of the Test Probe out of the receptacle
- Very robust

Mechanical Data

Center	4.00 mm/160 mil
Temperature Range	-30 °C - +120 °C
Full Travel	5.50 mm
Working Travel	4.40 mm
Pre-loaded Spring Force	0.20/ 0.20/ 0.40/ 0.50/ 0.80/ 0.70 N
Spring Force at Working Travel	0.40/ 0.60/ 1.50/ 2.25/ 3.00/ 5.00 N

Electrical Data

Max. Current Rating	5.0...8.0 A
Typical Continuity Resistance	<= 30 mOhm

Materials

Barrel	Brass, gold plated
Spring	Spring Steel, Stainless Steel, gold plated
Plunger	Steel
Receptacle	Brass, gold plated
Stranded Wire AWG 20 (Black)	Copper, tin plated, insulated

Recommended Diameter of Drill

HP 2361.1 (Trolitax)	3.00 mm
HGW 2372	3.01 mm

High-Temperature Applications

Temperature Range	-40 °C - +250 °C
Pre-Loaded Spring Force	0.40/ 0.40/ 0.80 N
Spring Force at Working Travel (Order Index E)	1.50/ 2.25/ 3.00 N

Available Screw Tools

Article Designation	max. Plate Diameter
WFS 1060/G-4.0-3.0	3.5
WFS 1060/G-5.0-4.0-Z	4.0
WFS 1060/G-6.0-5.0-Z	5.0
WFS 1060/G-5.0-3.0-SW	5.0

How to Order

1060/ G - D1013 - 1.5 N - Au - 1.00

1 2 3 4 5 6

1. Series 2. Threaded Design 3. Tip Style
4. Spring Force 5. Tip Plating 6. Tip Diameter

Tip style - Diameter - Plating

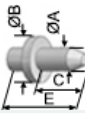

Tip Style	Tip-Ø mm A	Plate-Ø mm B	Tip Length mm C	Overall length mm D	Extension Height mm E	Screw Tool
BA2	1.80	4.00	3.00	29.00	11.20	WFS 1060/G-5.0-4.0-Z
BA3	1.80	4.00	2.50	29.00	11.20	- " -
BA5	1.80	4.00	2.50	28.50	10.70	- " -
BA7	1.80	4.00	2.10	29.00	11.20	- " -
BA71	1.80	4.00	2.10	29.00	11.20	- " -

BAx
Ni

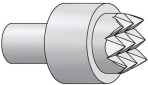

Tip Style	Tip-Ø mm A	Plate-Ø mm B	Tip Length mm C	Overall length mm D	Extension Height mm E	Screw Tool
C42	4.00	5.00 mm	1.00	28.50	10.70	WFS 1060/G-6.0-5.0-Z

C42
4.00 Ni

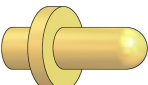

Tip Style	Tip-Ø mm A	Plate-Ø mm B	Tip Length mm C	Overall length mm D	Extension Height mm E	Screw Tool
D1001	1.40	3.50	2.40	28.90	11.10	WFS 1060/G-4.0-3.0
D1002	1.40	3.50	4.00	30.50	12.70	- " -
D1003	1.40	3.50	3.30	29.80	12.00	- " -
D1004	1.00	3.50	4.00	30.50	12.70	- " -
D1013	1.00	3.50	2.80	29.30	11.50	- " -

D1xxx
Au

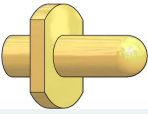

Tip Style	Tip-Ø mm A	Plate-Ø mm B	Tip Length mm C	Overall length mm D	Extension Height mm E	Screw Tool
D1904	1.00	3.50	4.00	30.50	12.70	WFS 1060/G-5.0-3.0-SW

Dx9xx
Au

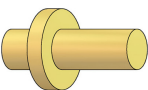

Tip Style	Tip-Ø mm A	Plate-Ø mm B	Tip Length mm C	Overall length mm D	Extension Height mm E	Screw Tool
F11	1.30	4.70	7.00	33.50	15.70	WFS 1060/G-6.0-5.0-Z
F12	1.30	4.70	5.00	33.50	15.70	- " -
F13	1.30	4.70	2.00	30.50	12.70	- " -
F14	2.60	4.00	1.80	29.00	11.20	WFS 1060/G-5.0-4.0-Z
F33	2.00	4.00	2.50	36.00	18.70	- " -
F40	1.50	4.00	2.65	28.50	10.70	- " -
F41	4.00	4.70	2.00	28.50	10.70	WFS 1060/G-6.0-5.0-Z
F1007	1.30	4.70	5.30	31.80	14.00	- " -
F1008	1.40	3.50	2.00	28.50	10.70	WFS 1060/G-5.0-4.0-Z
F1009	4.00	5.00	2.00	28.50	10.70	WFS 1060/G-6.0-5.0-Z
F1010	1.40	3.50	1.70	28.20	10.40	WFS 1060/G-5.0-4.0-Z
F1011	2.30	3.50	2.00	28.50	10.70	- " -
F1012	1.40	3.50	3.00	29.50	11.70	- " -
F1015	2.30	3.50	1.80	28.30	10.50	- " -
F1016	1.30	4.70	3.60	30.10	12.30	WFS 1060/G-6.0-5.0-Z
F1017	1.30	4.70	2.70	29.20	11.40	- " -
F1018	1.80	4.50	1.50	28.00	10.20	- " -

F1xxx
Au

Series 1060/G

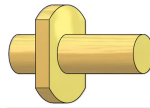

Fx9xx

Au

Tip Style	Tip-Ø mm A	Plate-Ø mm B	Tip Length mm C	Overall length mm D	Extension Height mm E	Screw Tool
F1907	1.30	4.70	5.30	31.80	14.00	WFS 1060/G-5.0-3.0-SW
F1909	4.00	5.00	2.00	28.50	10.70	- " -
F1916	1.30	4.70	3.60	30.10	12.30	- " -
F1917	1.30	4.70	2.70	29.20	11.40	- " -
F1918	1.80	4.50	1.50	28.00	10.20	- " -

1060/G

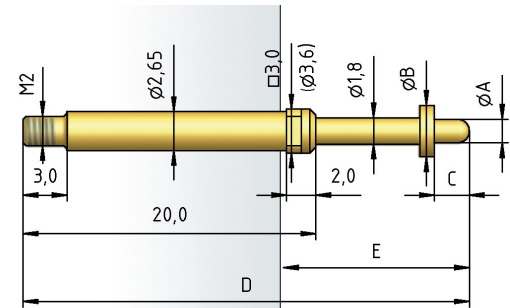

H 1060/G-L

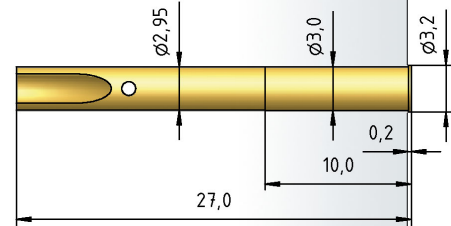

H 1060/GR-L



H 1060/GRV-L



This receptacle is sealed vacuum-tight when a wire is soldered on.
Important:
If too much solder is used there is a risk that it will get into the tread.

H 1060/GR-ST1.0

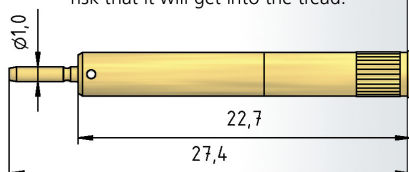

ST 1015-C1.0-V800
(without cable
ST 1015-C1.0)

